

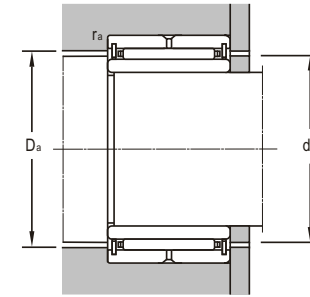

Needle Roller Bearings

single row  
with spring lock ring on outer ring

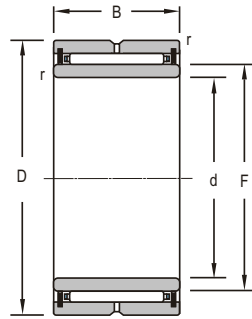

d 12~220mm

Boundary Dimensions					Basic Load Ratings		Limiting Speeds	
<i>d</i>	<i>D</i>	<i>B</i>	<i>F</i>	<i>r</i>	Dynamic <i>C</i>	Static <i>C<sub>0</sub></i>	Grease	Oil
mm					kN		r/min	
12	24	13	16	0.3	10.1	11.7	15000	23000
20	37	17	25	0.3	21.3	25.5	11000	16000
25	42	17	30	0.3	24	31.5	8500	13000
30	47	17	35	0.3	25.5	35.5	7500	11000
35	55	20	42	0.6	32	50	6600	9500
40	65	22	48	0.6	43.5	66.5	5500	8500
	62	22	48	0.6	43.5	66.5	5500	8500
45	68	22	52	0.6	45	72	5500	8000
50	72	22	58	0.6	48	80	5000	7000
55	85	25	63	1	58.5	99.5	4300	6000
	80	25	63	1	58.5	99.5	4500	6300
65	90	25	72	1	62.5	112	3700	5500
70	100	30	80	1	85.5	156	3300	5500
80	110	30	90	1	90.5	174	2900	4400
85	120	35	100	1.1	112	237	2500	3800
90	125	35	105	1.1	116	252	2500	3800
110	150	40	125	1.1	149	315	2100	3200
120	165	45	135	1.1	192	395	2000	3000
140	175	35	155	1.1	133	340	1700	2600
170	215	45	185	1.1	185	495	1500	2200
180	225	45	195	1.1	195	540	1400	2100
220	270	50	240	1.5	242	770	1100	1700

Bearing Designations		Mounting Dimensions			Mass
Present	Original	<i>d<sub>amin</sub></i>	<i>D<sub>amax</sub></i>	<i>r<sub>amax</sub></i>	
		mm			kg
NA4901	4524901	14	22	0.3	0.0303
NA4904	4524904K	22	35	0.3	0.0851
NA4905	4524905	27	40	0.3	0.0963
NA4906	4524906	32	45	0.3	0.109
NA4907	4524907	39	51	0.6	0.179
NA608	524708	44	58	0.6	0.315
NA4908	4524908	45	60	0.6	0.266
NA4909	4524909	49	64	0.6	0.298
NA4910	4524910	54	68	0.6	0.319
NA611	524711	61.5	78.5	1	0.562
NA4911	4524911	60	75	1	0.448
NA4913	4524913	70	85	1	0.521
NA4914	4524914	75	95	1	0.825
NA4916	4524916	85	105	1	0.91
NA4917	4524917	91.5	113.5	1	1.39
NA4918	4524918	96.5	118.5	1	1.43
NA4922	4524922	116.5	143.5	1	2.28
NA4924	4524924	126.5	158.5	1	2.96
NA4828	4524828	146.5	168.5	1	2.17
NA4834	4524834	176.5	208.5	1	4.31
NA4836	4524836	186.5	218.5	1	4.6
NA4844	4524844	228	262	1.5	7.12



